

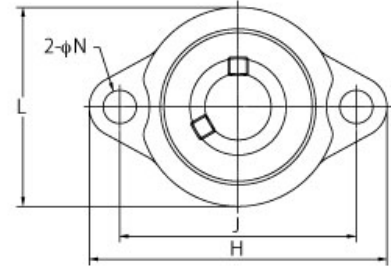

BLF204J

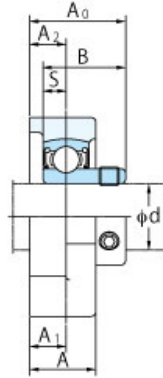

样式	
轴承座型号	LF204
轴承公称型号	SB204
轴径	20 mm
轴承座固定螺栓	M8 5/16 in
质量	0.33 kg 0.73 lb
轴固定方法	顶丝

主要尺寸	
H	90 mm 3-17/32 in
L	60 mm 2-3/8 in
A	20 mm 25/32 in
J	71.5 mm 2-13/16 in
N	10 mm 25/64 in
A1	11 mm 7/16 in
A2	11 mm 7/16 in
A0	29 mm 1-5/32 in
B	25 mm 0.984 in
S	7 mm 0.276 in

基本额定负荷	
Cr	12.8 kN 2878 lbf
Cor	6.65 kN 1495 lbf
系数 fo	13.2