

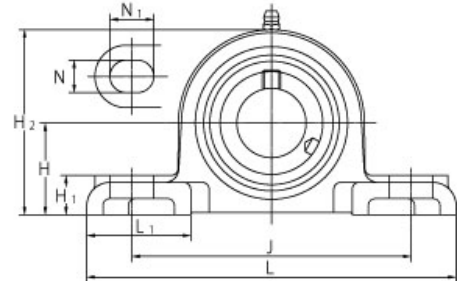

NAPK207-20J

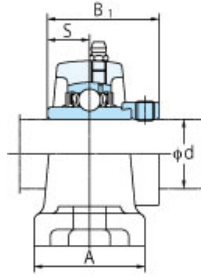

Specifications	
Housing Number	PK207
Bearing Number	NA207-20
Shaft Size	1-1/4 in
Bolt Size	1/2 in
Weight	2.0 kg 4.41 lb
Locking Style	Eccentric Collar Lock
Grease Fitting	A-1/4-28UNF

Dimensions	
H	46 mm 1-13/16 in
L	167 mm 6-9/16 in
A	48 mm 1-7/8 in
J	127 mm 5 in
N	14 mm 9/16 in
N1	19 mm 3/4 in
H1	19 mm 3/4 in
H2	92 mm 3-5/8 in
L1	45.5 mm 1-25/32 in
B1	51.1 mm 2.012 in
S	18.8 mm 0.740 in

Basic Load Rating	
Cr	25.7 kN 5778 lbf
Cor	15.4 kN 3462 lbf
Factor fo	13.9