

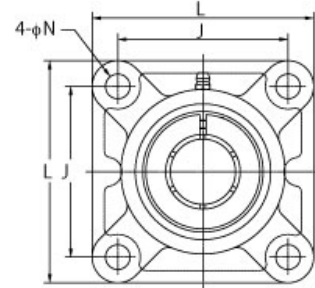

NCF205-16JE

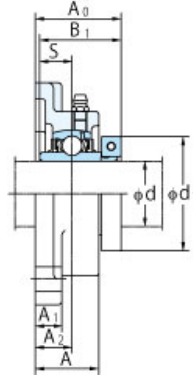

样式	
轴承座型号	F205E
轴承公称型号	NC205-16
轴径	1 in
轴承座固定螺栓	M10 3/8 in
质量	1.0 kg 2.20 lb
轴固定方法	同心套
适用油嘴	A-1/4-28UNF

主要尺寸	
L	95 mm 3-3/4 in
A	27 mm 1-1/16 in
J	70 mm 2-3/4 in
N	12 mm 15/32 in
A1	13 mm 1/2 in
A2	16 mm 5/8 in
A0	38.2 mm 1-1/2 in
B1	36.5 mm 1-7/16 in
S	14.3 mm 0.563 in
d1	49.2 mm 1-15/16 in

基本额定负荷	
Cr	14.0 kN 3147 lbf
Cor	7.85 kN 1765 lbf
系数 fo	13.9