

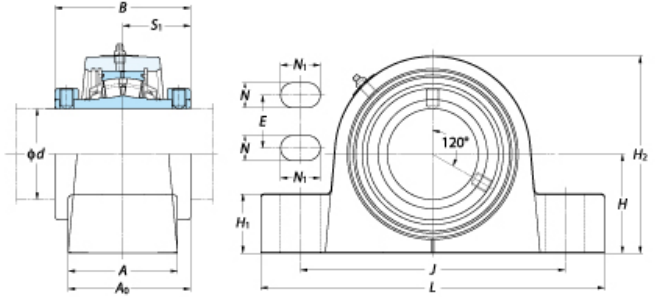

XDS4P418



样式		
轴承座型号	4P418	
轴承公称型号	XDS418	
轴径	90 mm	
轴承座固定螺栓	M20	3/4 in
轴固定方法	带顶丝固定圈（两侧）	
适用油嘴	A-NPT1/8	
主要尺寸		
H	95.2 mm	3-3/4 in
L	330 mm	13 in
A	105 mm	4-1/8 in
J	254 mm	10 in
N	24 mm	15/16 in
N1	38 mm	1-1/2 in
E	50.8 mm	2 in
H1	57 mm	2-1/4 in
H2	192 mm	7-9/16 in
A0	117.6 mm	4-5/8 in
B	130.2 mm	5.126 in
S1	65.1 mm	2.563 in
基本额定负荷		
C_r	284 kN	63910 lbf
C_{0r}	383.7 kN	86343 lbf